

NOTE:

- Proposals must comply with all acoustic, fire & building regulation requirements
- No dimensions are to be scaled from this drawing. The contractor is responsible for checking all dimensions on site

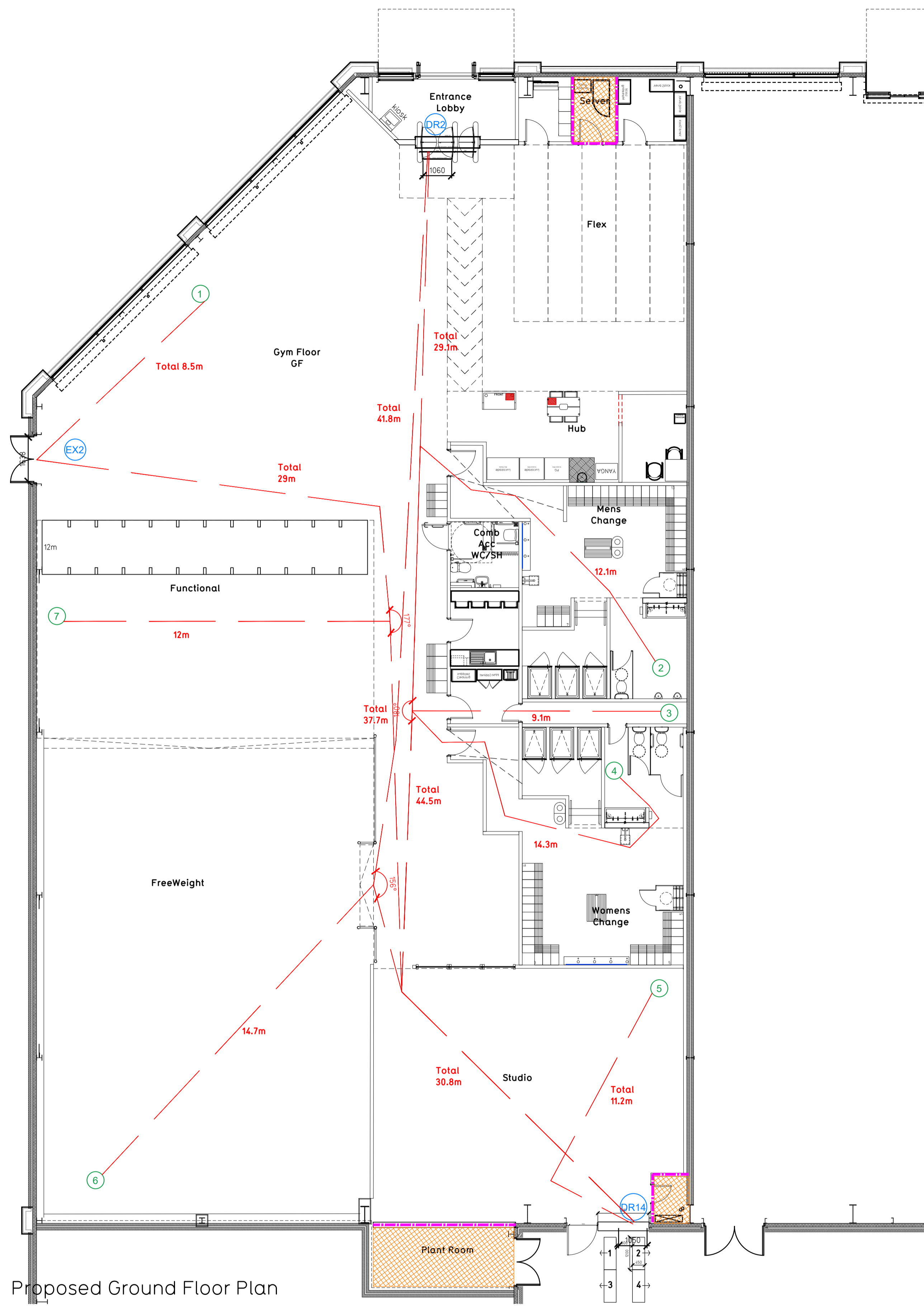

Proposed Ground Floor Plan

Fire Evacuation Key

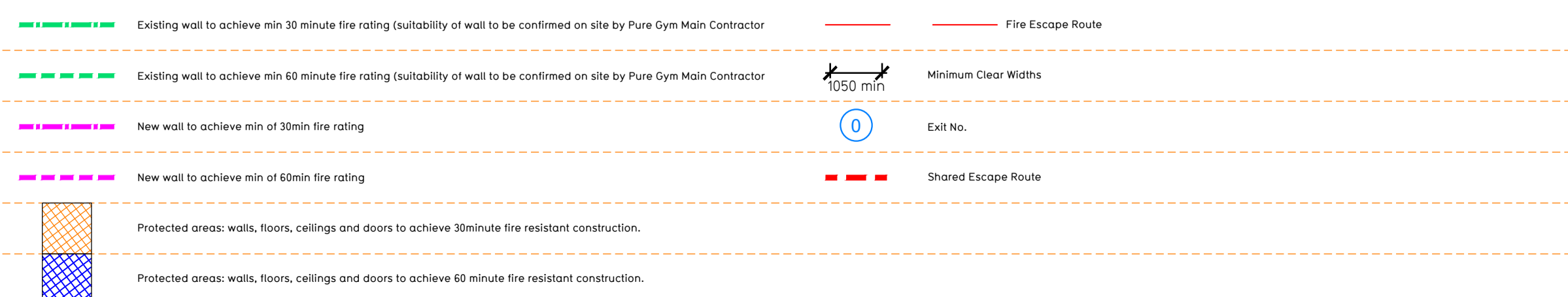

**Escape Route Widths:**  
 In line with Sections 3.21 & 3.22 of 'Approved Document Part B, Volume 2 - buildings other than dwellings' - the adjacent calculations provide justification for the clear opening widths for escape from each floor level/ room in accordance with Table 4 & Appendix C.

**Ground Floor**  
 Exit DR2 Clear Opening Width = 1050mm (allows 222 persons to escape)  
 Exit DR4 Clear Opening Width = 1050mm (allows 220 persons to escape)  
 Exit EX2 Clear Opening Width = 1038mm (allows 302 persons to escape, largest opening to be discounted)

Total Aggregate Width for Floor (Less Largest Opening Width of 1038mm from EXIT EX2) = 210mm  
 Ground Floor Total Estimated Occupancy Capacity = 472 Persons

Exit DR2 provides a min. width of 1050mm and would allow a max. No. of 222 persons to escape, which is larger than the total estimated occupancy capacity of 172 Persons and is therefore thought to meet with the Approved Document Part B.

**Sprinklers**  
 System design and installed in compliance with BS EN 12845:2015 & LPC Technical Bulletins

**Fire Alarm**  
 Fire Alarm designed and installed to BS 5839. Smoke & heat detection / emergency lighting by specialist. Please refer to MSE engineer's drawings / specifications.

**Escape Lighting**  
 Emergency escape lighted designed and installed in accordance with BS 5266: Part 1. Please refer to MSE Engineer's drawings for final layout and specification.

**Smoke Extract**  
 Smoke Extract System to be designed and installed in accordance with BS 7346: Part 8. Please refer to MSE Engineer's drawings for final layout and specification.

Escape Signage and emergency lighting is CDP under the MSE specification. Details of contractors proposals to be provided to Building Control Approved Inspector and Fire Officer within the Contractors Proposals Package, Clause 14.

Rev	Date	Description	DRAWING TITLE		Drawn/ Checked
Kirkby Retail Development - Unit 05 Fire Evacuation Plan					
Hall Lane, Kirkby, L32 8US Ground Floor Plans					
OT/MM	13.09.2022	SCALE	1:100 @ A1	DWG No.	2127b
DRAWING PURPOSE				DRAWING No.	003-FEP
CONSTRUCTION					Rev
					C00

Pure Gym Ltd  
 Town Centre House  
 The Merrion Centre  
 Leeds  
 LS2 8LY  
 e: architecture@puregym.com  
 t: 0113 285 8787  
 w: www.puregym.com