

FIRST FLOOR

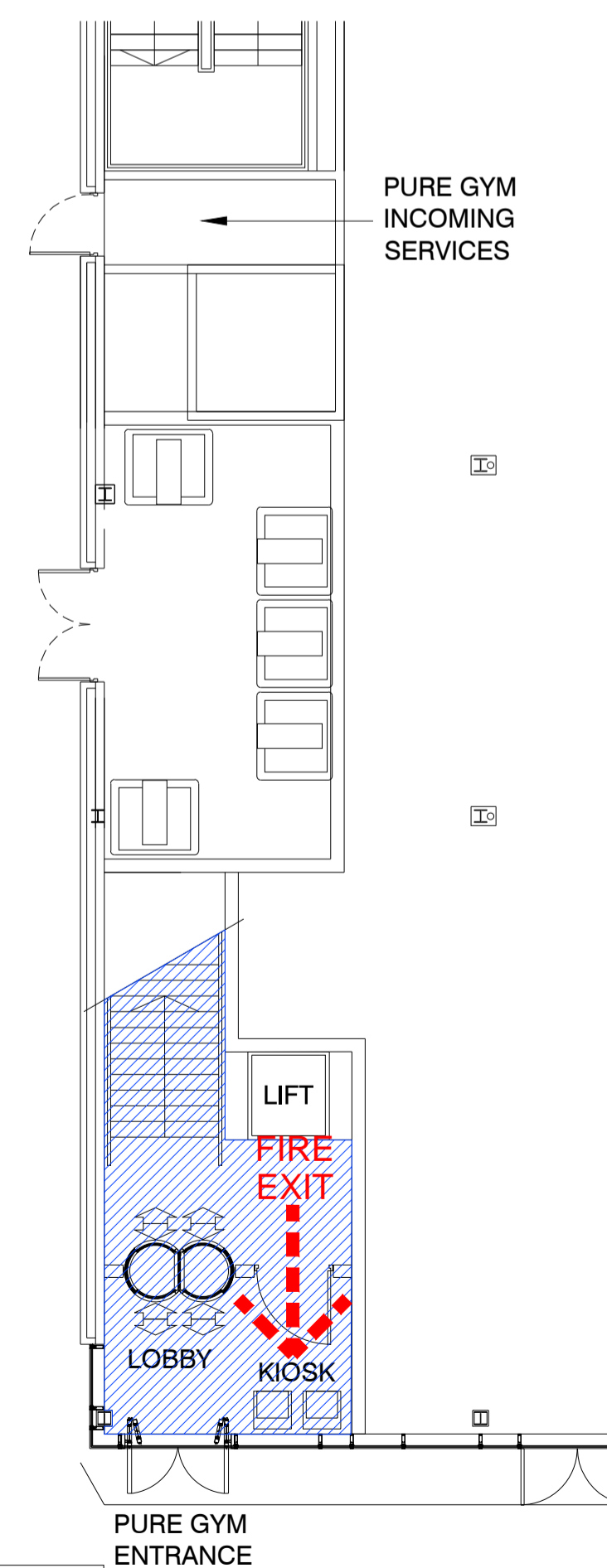

GROUND FLOOR

PURE GYM AREA (RED LINE)  
 GROUND FLOOR = 29.5m<sup>2</sup> / 317.5ft<sup>2</sup>  
 FIRST FLOOR = 1,432.3m<sup>2</sup> / 15,417ft<sup>2</sup>  
 TOTAL AREA = 1,461.8m<sup>2</sup> / 15,734.7ft<sup>2</sup>

MICHAEL HYDE AND ASSOCIATES LIMITED  
 chartered architects

MANCHESTER ■ SHEFFIELD □

51 BARTON ARCADE  
 DEANSGATE  
 MANCHESTER M3 2BU  
 TEL: 0161 834 1018  
 FAX: 0161 834 4798  
 Manchester@MHA  
 architects.com

ABBAY HOUSE  
 11 LEOPOLD STREET  
 SHEFFIELD S1 2DQ  
 TEL: 0114 272129  
 FAX: 0114 2753043  
 Sheffield@MHA  
 architects.com

REV	DATE	DESCRIPTION	DRW	CHK
PROJECT TITLE PURE GYM LTD BRIDGE ROAD, KIRKSTALL				
DRAWING TITLE GROUND AND FIRST FLOOR FIRE EVACUATION PLAN				
DRAWN/CHECKED CM/GL		DATE AUG 2015	SCALE 1:100 @ A1	
JOB No 1PG123		DRAWING 2-600	REVISIONS -	