

Proposed Ground Floor Plan

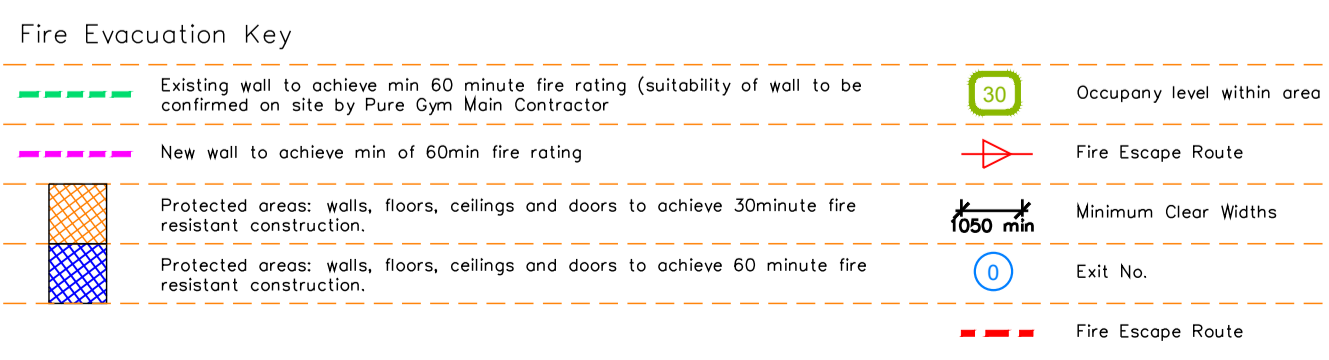

Illuminated signage to be relocated - access to service door to be retained

Escape Route Widths
 In line with Sections 3.21 & 3.22 of 'Approved Document Part B, Volume 2 - buildings other than dwellings' - the adjacent calculations provide justification for the clear opening widths for escape from each floor level/ room in accordance with Table 4 & Appendix C.

Ground Floor
 Exit 1 Clear Opening Width = 850mm (allows 10 persons to escape)
 Exit 2 Clear Opening Width = 1100mm (largest opening to be discarded)
 Total Aggregate Width to Floor (Less Largest Opening Width of 1100mm from Exit 2) = 850mm
 Ground Floor Total Estimated Occupancy Capacity = 107 Persons
 Exit 1 provides a min. width of 850mm and would allow a max. No. of 110 persons to escape, which is larger than the total estimated occupancy capacity of 107 Persons and is therefore thought to meet with the Approved Document Part B.

Sprinklers
 System design and installed in compliance with BS EN 12845:2015 & LPC Technical Bulletins

Fire Alarm
 Fire Alarm designed and installed to BS 5839. Smoke & heat detection / emergency lighting by specialist. Please refer to M&E engineer's drawings / specifications.

Escape Lighting
 Emergency escape lighting designed and installed in accordance with BS 5266: Part 1. Please refer to M&E Engineer's drawings for final layout and specification.

Rev	Date	Description	Drawn / Check
A	11.03.19	Updated following pre-start meeting.	AT / PG

PROJECT TITLE		DRAWING TITLE	
Quatermile One		Fire Escape Plans	
15 Lauriston Pl, Edinburgh EH3 9EN		Ground Floor	
DRAWN / CHECKED	DATE	SCALE	JOB No.
AT / GL	06.02.19	1:100 @ A2	IA-R-022
DRAWING REVISIONS	DATE	DESCRIPTION	REV

CONSTRUCTION

PUREGYM

Pure Gym Ltd
 Town Centre House
 The Merrion Centre
 Leids
 LS2 8LY

© architecture@puregym.com
 t. 0115 225 8787
 w. www.puregym.com